

# MVSI 9 ELECTRIC VIBRATOR SERIES

## three-phase

8 poles		
Hz	50	60
RPM	750	900



DESCRIPTION						MECHANICAL FEATURES						ELECTRICAL FEATURES			
Part Number	Model	Design	Frame Size	SP	Ex I/2D Temp. Class	Static Moment* in-lbs		Centrifugal Force lbs		Weight lbs		Power Output HP		Max Current A	
						50 Hz	60 Hz	50 Hz	60 Hz	50 Hz	60 Hz	50 Hz	60 Hz	400 V 50 Hz	460 V 60 Hz
602568	MVSI 9-340	S02	20	•	130°C	14.2	14.2	229	328	41.8	41.8	0.15	0.20	0.85	0.76
602575	MVSI 9-590	S02	30	•	130°C	24.9	24.9	398	572	60.5	60.5	0.25	0.28	1.10	1.05
602615	MVSI 9-910	S02	35	•	120°C	39.7	39.7	634	913	80.3	80.3	0.19	0.20	0.60	0.68
602616	MVSI 9-1160	S02	35	•	120°C	50.4	50.4	803	1162	90.2	90.2	0.19	0.20	0.60	0.68
602609	MVSI 9-1440	S08	40	•	120°C	62.9	62.9	1003	1443	106	106	0.28	0.35	1.20	1.20
602610	MVSI 9-2030	S08	50	•	120°C	88.0	88.0	1401	2017	128	128	0.29	0.40	1.40	1.30
602618	MVSI 9-2920	S08	60	•	150°C	127	127	2028	2919	183	183	0.87	1.1	2.20	2.20
602619	MVSI 9-3850	S08	60	•	150°C	168	168	2671	3843	205	205	1.0	1.2	2.60	2.26
602891	MVSI 9-4640	S02	70	•	135°C	202	202	3219	4635	286	286	1.4	1.8	4.10	4.20
602884	MVSI 9-6830	S02	80	•	135°C	298	298	4734	6818	414	414	2.0	2.0	5.40	5.20
602515	MVSI 9-8400	S02	80	•	135°C	366	366	5819	8378	449	449	2.5	3.0	6.00	6.00
602862	MVSI 9-9310	S02	90	•	135°C	405	405	6446	9280	524	524	2.7	3.2	6.50	6.50
602826	MVSI 9-11700	S02	90	•	135°C	508	508	8078	11631	590	590	4.0	4.3	8.20	7.85
602827	MVSI 9-14400	S90	95	°	135°C	626	626	9957	14337	693	693	5.0	5.8	9.90	9.50
602551	MVSI 9-14500	S02	97	°	135°C	638	638	10155	14623	726	726	5.6	6.0	10.5	10.0
602870	MVSI 9-21900	S02	97	°	135°C	1077	954	17142	21861	964	922	7.1	8.5	13.2	12.0
602863	MVSI 9-24800	S90	100	°	135°C	1201	1079	19116	24717	1188	1144	7.6	8.7	14.0	13.5
602871	MVSI 9-31000	S02	105	°	135°C	1560	1348	24827	30879	1544	1496	10.2	11.0	21.0	19.5
602872	MVSI 9-38000	S02	105	°	135°C	1855	1658	29520	37979	1661	1564	11.9	12.7	22.0	20.0
602873	MVSI 9-49000	S90	110	°	135°C	2490	2131	39611	48822	2233	2158	14.7	17.5	26.5	28.0
602535	MVSI 9-57000	S90	110	°	135°C	-	2490	-	57039	-	2233	-	17.4	-	28.0

-  ° CSA Approval available if factory wired.
-  CSA Approval for Class I, Division 2, Groups A, B, C and D hazardous locations. Available upon request.
-  Product approved for European Directive 94/9/EC (EN 61241-0, EN 61241-1): ATEX II2D, tD A21 IP66 (temperature class detailed in table).
-  All listed products are in compliance with GOST R 51330.0-99, GOST R 51330.1, GOST R 51330.8-99, GOST R IEC 61241-1-1-99.
-  Product approved for IECEx Scheme following IEC 61241-0, 61241-1: II2D, tD A21 IP66 (Temperature class detailed in table).
-  In compliance with all applicable European Directives.

\* Working Moment = 2 x Static Moment. Static Moment = Unbalance.  
For 230 V, 60 Hz amperage, double the 460 V, 60 Hz amperage.

# MVSI 9 ELECTRIC VIBRATOR SERIES

## three-phase

8 poles		
Hz	50	60
RPM	750	900



OVERALL DIMENSIONS (inches)

Model	Design	Type	A	B	C	D	E	Foot holes		F	H	I	L	M	N
								øG	N°						
MVSI 9-340	S02	A	13.54	7.99	6.57	4.13	5.51	0.51	4	1.18	3.25	3.66	5.71	5.51	6.30
MVSI 9-590	S02	A	15.51	8.50	8.07	4.72	6.69	0.67	4	1.77	3.68	4.17	6.69	6.30	7.17
MVSI 9-910	S02	A	17.13	8.86	8.07	4.72	6.69	0.67	4	2.13	4.11	4.63	7.36	6.38	7.99
MVSI 9-1160	S02	A	18.90	8.86	8.07	4.72	6.69	0.67	4	2.13	4.11	5.51	7.36	6.38	7.99
MVSI 9-1440	S08	A	19.69	9.69	9.06	5.51	7.48	0.67	4	2.13	4.57	5.28	8.15	7.48	8.86
MVSI 9-2030	S08	A	22.60	9.69	9.06	5.51	7.48	0.67	4	2.13	4.57	6.73	8.15	7.48	8.86
MVSI 9-2920	S08	A	24.29	10.71	10.83	6.10	8.86	0.87	4	2.76	5.12	6.97	9.37	8.27	9.96
MVSI 9-3850	S08	A	24.29	10.71	10.83	6.10	8.86	0.87	4	2.76	5.12	6.97	9.37	8.27	9.96
MVSI 9-4640	S02	A	26.22	12.64	12.20	6.10	10.04	0.93	4	3.03	6.18	7.01	10.91	8.46	11.61
MVSI 9-6830	S02	A	28.90	13.66	13.39	7.09	11.02	1.02	4	3.15	6.50	7.95	11.93	9.45	12.60
MVSI 9-8400	S02	A	31.34	13.66	13.39	7.09	11.02	1.02	4	3.15	6.50	9.17	11.93	9.45	12.60
MVSI 9-9310	S02	A	29.29	14.57	15.35	7.87	12.60	1.10	4	3.54	7.09	7.56	12.99	10.63	13.78
MVSI 9-11700	S02	A	33.07	14.57	15.35	7.87	12.60	1.10	4	3.54	7.09	9.45	12.99	10.63	13.78
MVSI 9-14400	S90	A	34.25	15.55	15.43	7.87	12.60	1.10	4	3.94	7.56	10.04	13.98	10.63	14.76
MVSI 9-14500	S02	C	33.94	17.20	18.11	4.92	14.96	1.54	6	1.38	8.46	9.06	15.24	12.60	16.30
MVSI 9-21900	S02	C	39.45	17.20	18.11	4.92	14.96	1.54	6	1.38	8.46	11.81	15.24	12.60	16.30
MVSI 9-24800	S90	C	42.13	17.87	20.87	5.51	17.32	1.77	6	1.50	9.06	11.02	16.65	14.57	17.64
MVSI 9-31000	S02	F	40.94	20.71	22.44	5.51	18.90	1.77	8	1.61	10.55	9.45	19.13	20.08	20.31
MVSI 9-38000	S02	F	44.09	20.71	22.44	5.51	18.90	1.77	8	1.61	10.55	11.02	19.13	20.08	20.31
MVSI 9-49000	S90	F	45.28	23.90	24.02	5.51	20.47	1.77	8	1.50	11.69	11.71	21.34	20.08	22.91
MVSI 9-57000	S90	F	45.28	23.90	24.02	5.51	20.47	1.77	8	1.50	11.69	11.71	21.34	20.08	22.91

Type A

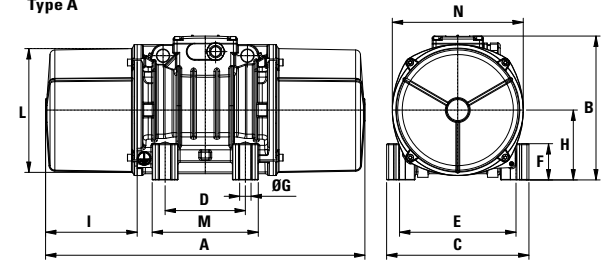

Type C

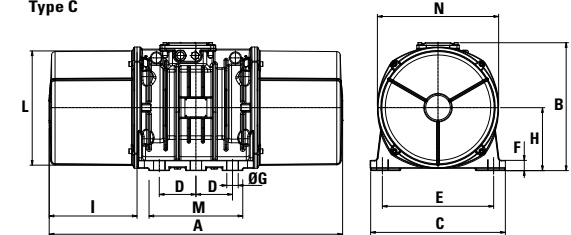

Type F

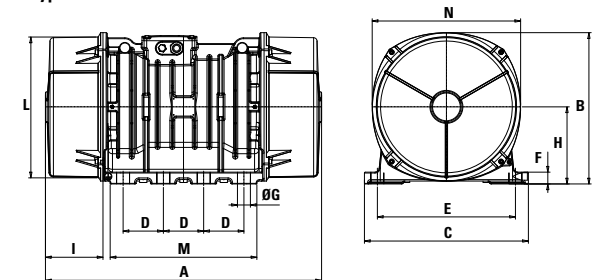

Several sizes are available with different mounting bolt patterns. Please contact sales office at Italvibras.